

NEWS AND ANNOUNCEMENTS OF THE LUTHERAN CHURCH OF THE MESSIAH

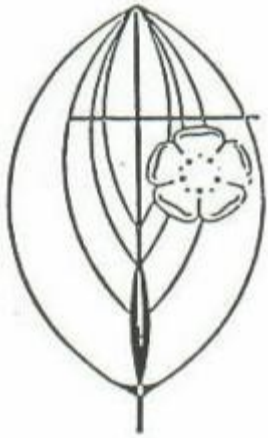

Messiah Messenger

407 Nassau Street Princeton NJ 08540
Church Email: lcmprinceton@gmail.com
Website: www.princetonlutheranchurch.org

THE REV. DR.
MARTIN K. ERHARDT
PASTOR

THE REV. DR.
JOHN MARK GOERSS
PASTOR EMERITUS

JANICE HOFREITER
ORGANIST AND
CHOIR DIRECTOR

EVA GROVES
CHURCH SECRETARY
EVA.M.GROVES@GMAIL.COM

FROM THE PASTOR'S DESK

My Will and Thy Will

Writing this in the second week of August, I'm struck, as I often am at this time of year, by how little summer is left before we return to our school-year schedule at Messiah. Whatever the season, urgent tasks compete with important ones for our attention. We often move things that don't need to be done immediately to the back burner and leave them there. Meanwhile, time marches on.



With our future in God's hands, we need not fear the passage of time. God's gift of eternal life frees us from frenzied exploitation of all the world has to offer lest we miss out on something before we die. Instead, we cherish the time and other resources God has given us – holding them gently and trying to manage them well.

Planning that management, or stewardship, is an important task we often neglect when faced with more urgent matters. Retrieving stewardship of time and financial resources from the back burner is the subject of an upcoming estate planning seminar sponsored by Lutheran congregations of the Mercer Mission Cluster. Entitled *My Will and Thy Will*, the seminar is designed

Continued on next page

FROM THE PASTOR'S DESK (CONT'D)

to help adults of all ages integrate Christian stewardship principles into their asset allocation and estate plans. It will provide theological foundations and practical guidance on topics that can be hard to talk about with people we love, e.g. wills and trusts, providing for dependents, funeral planning, advance directives and power of attorney, age-appropriate asset allocation, gift-giving priorities, and talking about money with others.

The seminar is scheduled for 2:00-5:00pm on Sunday, October 6. Location TBA. More information will be published in the coming weeks. Enjoy the rest of the summer, and before it slips by, mark your calendar to join us on October 6!

Pastor Erhardt

LORD'S PRAYER MNEMONICS

Pastor Erhardt's mnemonics for remembering parts of the Lord's Prayer in the July 28 children's sermon inspired many more from the congregation. The ostensible goal was to remember one key word from each of the following lines:

... hallowed be thy name
... thy kingdom come
Give us this day our daily bread;
and forgive us trespasses

Pastor's mnemonics using the first letter of each word (N, K, B, F):

New Kites Blow Far
New King Born Friday

From the congregation:

Noble Kings Befriend Foes
Naughty Kings Behead Foes
Noble Kindred, Believe Faithfully
Never Kiss Bawdy Females
Nimble Koalas Boogie-Woogie Friskily
Noteworthy Kindness, Brothers Forever

Which is your favorite?

Visit our website to listen to audio recordings of Sunday Sermons.

<http://www.princetonlutheranchurch.org/services.html>

SAVE THE DATES

Saturday, September 7



**THIRTIETH
ISI ANNUAL GARAGE GIVE-AWAY FOR EVERY
INTERNATIONAL STUDENT AND SCHOLAR**

PLACE: LUTHERAN CHURCH OF THE MESSIAH
407 NASSAU STREET & CEDAR LANE
PRINCETON, NJ 08540

DATE: SATURDAY, SEPTEMBER 7, 2013 (Rain Date 9/14)

TIME:	8:00 – 9:00 A.M.	DELIVERY TIME
	8:00 – 10:00 A.M.	SET UP TIME
	10:00 – 11:00 A.M.	OPEN TO STUDENTS & SCHOLARS
	11:00 – 12:00 Noon	CLEAN UP TIME

HELPERS ARE NEEDED BETWEEN 8:00 A.M. – 12:00 Noon
Drivers with pick ups are needed for: Sept. 7, 14.

MUCH SOUGHT AFTER ITEMS:

I KITCHEN:	POTS & PANS, DISHES, SILVERWARES
BED & BATH:	SHEETS, BLANKETS, PILLOWS, TOWELS, COMFORTERS, THROW RUGS
APPLIANCES & FURNITURE:	BICYCLES, TOASTERS, IRONS, ELECTRIC HEATERS, FANS HEATERS, FANS DESKS, DINETT, LAMPS, CHAIRS, COUCHES, BEDS, BOOKSHELVES

NOT NEEDED: TELEVISIONS, COMPUTERS, MONITORS,
TOYS, CLOTHES, GAMES, BOOKS,
CURTAINS, DRAPES.

* DONATED ITEM MUST BE IN GOOD AND WORKING CONDITION.

** PLEASE INFORM US IF LARGER ITEMS (COUCHES,
BEDS, ETC.) ARE AVAILABLE SO THAT ARRANGEMENTS CAN
BE MADE FOR PICK UP AT A FUTURE DATE.

*** FOR FURTHER INFORMATION PLEASE CONTACT ISI CHURCH'S

DENNIS GUDZ	(908) 534-9408	dvqudz@yahoo.com
JIM JOHNSON	(908) 369-4821	mijinosnhoj@aol.com
JOHN & ARUNA DESAI	(609) 924-0763	jdesai45@verizon.net

INTERNATIONAL STUDENTS, 45 Oakland Road, Princeton, NJ 08540

SAVE THE DATES

Sunday, September 8

Sunday worship reverts to 10:30am and Christian education classes begin.

Sunday, September 15

Thrivent Financial to host Messiah fellowship hour.

Sunday, October 6

My Will and Thy Will financial planning seminar, 2–5 PM; Location TBA

How can we be faithful stewards of God's resources over the long run? This seminar is designed for adults of all ages to help you integrate principles of Christian stewardship into your asset allocation and estate plans. Please plan to join us to address these important but frequently overlooked issues. Sponsored by the Lutheran congregations of the Mercer Mission Cluster.

See fellowship events on page 8 for more dates to save.

TEMPLE SERVANTS

In preparation for the October—January 2014 Temple Servant schedule. Please email Eva with dates you will be unavailable to serve by September 15.

September Temple Servants

Date	Acolyte	Reader	Ushers	Host	Driver	Chancel
Sept 1 9:30	Gail Sabatura	Carolyn Gishlick	Robert Coyner / Miranda Hempel	Lottie Coffin	~	Esther Fischer
Sept 8 10:30	Carolyn Gishlick	Peter Knight	John & Esther Fischer	Karen Hartl	Peter Giller	Esther Fischer
Sept 15 10:30	Jon Hlafter	Debbie Baer	Werner & Karen Hartl	Debbie Zak/ THRIVENT	Peter Giller	Carolyn Gishlick
Sept 22 10:30	Stephen Bamgbade	Jon Hlafter	Eva Groves/ Doris Gerwers	Gail Sabatura	Jon Hlafter	Gail Sabatura
Sept 29 10:30	Gail Sabatura	Peter Knight	Stephen Stys / David Steinnagel	Christine Knight	Jon Hlafter	Gail Sabatura

CONGRATULATIONS

Congratulations to Mark Yunque and Laura Lover who were married by Pastor Erhardt in Battery Park on Saturday, July 27!



Pastor Erhardt officiates at the wedding of Mark Yunque and bride Laura Lover.



What fun! The first dance, "Putting on the Ritz".

CONGRATULATIONS

Nancy and Roger Amidon will celebrate their 35th wedding anniversary on September 9th.

Ruth Carlough will celebrate her 90th birthday on September 10th.

UPCOMING READINGS

<u>Proper 17 (22)</u> Fifteenth Sunday after Pentecost September 1, 2013 ART -- PRAYER	Jeremiah 2:4-13 Psalm 81:1, 10-16	Hebrews 13:1-8, 15-16	Luke 14:1, 7-14
<u>Proper 18 (23)</u> Sixteenth Sunday after Pentecost September 8, 2013 ART -- PRAYER	Jeremiah 18:1-11 Psalm 139:1-6, 13-18	Philemon 1:1-1:21	Luke 14:25-33
<u>Proper 19 (24)</u> Seventeenth Sunday after Pentecost September 15, 2013 ART -- PRAYER	Jeremiah 4:11-12, 22-28 Psalm 14	1 Timothy 1:12-17	Luke 15:1-10
<u>Proper 20 (25)</u> Eighteenth Sunday after Pentecost September 22, 2013 ART -- PRAYER	Jeremiah 8:18-9:1 Psalm 79:1-9	1 Timothy 2:1-7	Luke 16:1-13
<u>Proper 21 (26)</u> Nineteenth Sunday after Pentecost September 29, 2013 ART -- PRAYER	Jeremiah 32:1-3a, 6-15 Psalm 91:1-6, 14-16	1 Timothy 6:6-19	Luke 16:19-31
<u>Proper 22 (27)</u> Twentieth Sunday after Pentecost October 6, 2013 ART -- PRAYER	Lamentations 1:1-6 Psalm 137	2 Timothy 1:1-14	Luke 17:5-10
<u>Proper 23 (28)</u> Twenty-First Sunday after Pentecost October 13, 2013 ART -- PRAYER	Jeremiah 29:1, 4-7 Psalm 66:1-12	2 Timothy 2:8-15	Luke 17:11-19
<u>Proper 24 (29)</u> Twenty-Second Sunday after Pentecost October 20, 2013 ART -- PRAYER	Jeremiah 31:27-34 Psalm 119:97-104	2 Timothy 3:14-4:5	Luke 18:1-8
<u>Proper 25 (30)</u> Twenty-Third Sunday after Pentecost October 27, 2013 ART -- PRAYER	Joel 2:23-32 Psalm 65	2 Timothy 4:6-8, 16-18	Luke 18:9-14

OUR GREEN CHASUBLE HAS ARRIVED AT LAST!



LOOKING FOR HOST FAMILIES

Several university students from the Lutheran Student Fellowship of Pittsburgh plan to attend a conference sponsored by the Love & Fidelity Network (www.loveandfidelity.org) at Princeton University on November 8 and 9, and to worship with us on Sunday, November 10.



They are looking for families willing to host students the nights of Friday, Nov. 8, and Saturday, Nov. 9. Hosts are not expected to provide meals. If you are willing and able to host students, please contact the church office (609-924-3642; lcmaprinceton@gmail.com)

THRIVENT WOMEN AND MONEY SEMINAR

When: Wednesday, September 18 from 6:30pm to 8:30pm

Where: Elements Community Clubhouse, 20 Murano Drive, West Windsor, NJ.

RSVP: lynda.dillman@thrivent.com , 609-357-0497

For more information , see the church bulletin board in the basement



BLAST FROM THE PAST



Messiah in the year ____? (give or take 5)

Notice the landscaping?

WORSHIP SCHEDULE

WORSHIP SERVICE

9:30am Summer worship June 2nd - September 1

10:30am Sunday worship will resume September 8

Christian education classes begin Sept. 8th at 9:00am.

FELLOWSHIP EVENTS

Saturday, September 21 at 6:00pm

Church potluck in the fellowship hall at 6:00 pm. Please bring one main dish and one side. Pastor Erhardt will show slides from coastal Alaska and Canada, so seafood dishes are encouraged.

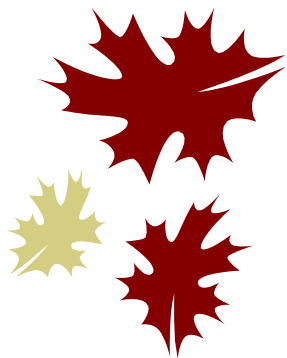
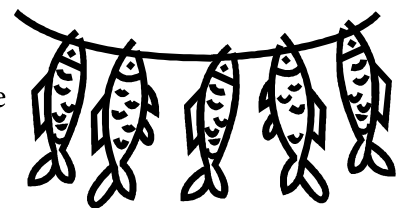

Saturday, October 26, 10:00am—4:00pm

Messiah Fall Work Day

Come when you can and leave when you must. We'll have plenty of work to go around for people of all ages and abilities. Gardening volunteers, please bring gloves and tools. It's fun, lunch is provided, and your help is greatly appreciated!

MESSIAH'S MANTLES: PRAYER SHAWL MINISTRY



Left to Right: Kersti Alabert, Lottie Coffin, Esther Fischer, Mildred Coyner, Doris Gerwers, Siv Mitt, Patricia Hlafter, Patricia Wolf, and Eva Groves.

The Celebration of Craft Ministries was hosted by Thrivent at Good Shepherd Lutheran Church in Somerville, NJ, on Saturday, July 13th. Several churches in the area were represented. A delicious luncheon was served as we shared our crafting ideas and projects.

Messiah donated five prayer shawls to the Lutheran Medical Center in Brooklyn after listening to Pastor Stiger as he shared his experiences after Hurricane Sandy and the real need that still exists in many places today. Many thanks to the ladies of Messiah's Mantles!



Join us on September 19th for our first meeting of the fall season:

7:00pm at Mildred Coyner's home. Bring your in-progress needlepoint work.

Mildred will celebrate her 91st birthday on September 26th.

LANDSCAPING UPDATE

by Miranda Hempel

More Landscaping Improvements in the Future for Messiah

The summer weather has been kind to Messiah's new trees and shrubs. The day after they were planted, it poured, and it continued to rain hard every two or three days for about a month, long enough for the trees to get adjusted to their new home and start to grow. The shrubs, which were planted before the trees, have really taken off, and now are awaiting a haircut to keep their growth nice and dense. The trees will continue to need TLC for some time, but Charlie Peterson of Peterson's Nursery checked them out about two weeks ago and pronounced them healthy and hearty.

Mr. Peterson was at Messiah scoping out the lay of the land for two new shrub and flower areas to be planted in the fall and spring. A triangular flower and shrub bed is being planned for the corner of Nassau St. and Cedar Lane, possibly featuring a ribbon of mixed daffodils and day lilies, as well as some ornamental evergreens and a dwarf Japanese Maple reaching a maximum height of 3-4 feet. (see sketch at right).

Tentative Plan for Corner Bed

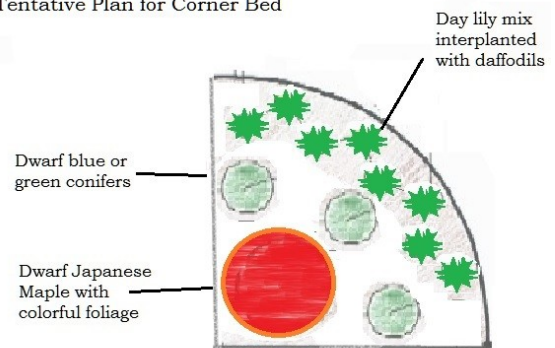

A larger bed on the slope between the sidewalk and the church walk on the side of the building will feature shade-tolerant plants like heucheras, hostas, astilbes, hydrangeas, and ferns.



Heuchera in bloom - pink flower spires above silver and dark green veined leaves.



Flowering hosta with variegated chartreuse and deep green leaves.



Light pink Astilbe blossom atop dark ferny foliage.

continued on next page

Heucheras (also known as coral bells for their flowers) and hostas (with the rather unattractive alternative moniker of funkia) come in a dazzling array of colors which will brighten up that area. Heuchera have leaves of yellow, chartreuse, green, pink, peach, burgundy, red, and green and white veined, depending on the variety. Astilbes have delicate fern-like foliage and wonderful spires of fluffy flowers in whites, pinks, purples, and reds.

Meanwhile, Saturday, October 26, has been designated Messiah Fall Work Day. Mark your calendars and plan to come help plant bulbs for an even more beautiful display this coming spring, along with weeding (alas, always necessary; five minutes after being weeded, the flowerbeds will have new weeds springing up!) and pruning. I hope you can make it!

We have been fortunate to receive donations for the landscaping, which have allowed us to widen the scope of our plantings. Many people have helped with weeding, planting, **THANK YOU!** pruning, and maintenance over the year, which is vital, because it is really quite alarming how quickly weeds and shrubs can grow out of bounds without regular grooming! Thanks as well to those who have helped out by sharing ideas, impressions, and kind words!

KNEELERS

With the help of a generous benefactor, kneelers have been purchased for those who have requested them.

Please see Eva or Pastor if you would like to request or sponsor the purchase of additional kneelers.



September 2013

Sun	Mon	Tue	Wed	Thu	Fri	Sat
1 9:30 am Holy Communion	2	3	4 8pm Choir	5	6	7 ISI Garage Give Away
8 9:00 Christian Education 10:30 am Holy Communion	9	10	11 8pm Choir	12 7pm Executive Board Meeting	13	14 Raindate for ISI
15 9:00 Christian Education 10:30 am Holy Communion	16	17	18 8pm Choir	19 7pm Prayer Shawl	20 6pm ISI Dinner	21 6pm Potluck Dinner
22 9:00 Christian Education 10:30 am Holy Communion	23	24	25 8pm Choir	26	27	28
29 9:00 am Christian Education 10:30 am Holy Communion	30					

October 2013

Sun	Mon	Tue	Wed	Thu	Fri	Sat
		1	2 8pm Choir	3	4	5
6 9:00 Christian Education 10:30 am Holy Communion 2-5pm My Will & Thy Will	7	8	9 8pm Choir	10 7pm Executive Board Meeting	11	12
13 9:00 Christian Education 10:30 am Holy Communion	14	15	16 8pm Choir	17	18 6pm ISI Dinner	19
20 9:00 Christian Education 10:30 am Holy Communion	21	22	23 8pm Choir	24	25	26 Fall Work Day 10-4pm
27 9:00 Christian Education 10:30 am Holy Communion	28	29	30 8pm Choir	31		